

**SBU: MJIC X MJIC TUBE UNION**

MATERIAL: BRASS  
 ASTM: B-16  
 TYPE: CA-360  
 TEMP RANGE: -65° - 250° F

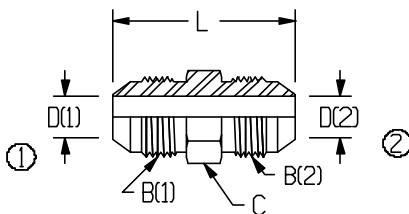

PART NO	TUBE OD	B (1) UN/UNF-2A	B (2) UN/UNF-2A	L	C	D (1)	D (2)	Working Pressure
SBU44	1/4-1/4	7/16-20	7/16-20	1.35	0.44	0.17	0.17	3250 psi
SBU66	3/8-3/8	9/16-18	9/16-18	1.41	0.63	0.30	0.30	3250 psi
SBU88	1/2-1/2	3/4-16	3/4-16	1.62	0.81	0.39	0.39	3250 psi
SBU1010	5/8-5/8	7/8-14	7/8-14	1.83	0.94	0.48	0.48	3250 psi
SBU1212	3/4-3/4	1 1/16-12	1 1/16-12	2.14	1.13	0.61	0.61	3250 psi
SBU1616	1" - 1"	1 5/16-12	1 5/16-12	2.25	1.38	0.84	0.84	2600 psi

