

PLJ: PUSH-ON HOSE BARB X MJIC

MATERIAL: BRASS
 ASTM: B16
 TYPE: CA-360
 TEMP RANGE: -40° - 200° F

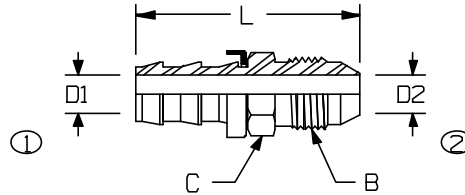

PART NO	HOSE I.D.	TUBE O.D.	B UN/UNF-2A	L	BARB LENGTH	C	D1	D2	Working Pressure
PLJ44	1/4	1/4	7/16-20	1.44	.735	.438	.185	.185	300 psi
PLJ66	3/8	3/8	9/16-18	1.786	.993	.624	.278	.292	300 psi
PLJ88	1/2	1/2	3/4-16	1.981	1.066	.874	.395	.390	300 psi
PLJ1010	5/8	5/8	7/8-14	2.619	1.186	.941	.483	.485	300 psi
PLJ1212	3/4	3/4	1-1/16-12	2.790	1.583	1.123	.605	.609	300 psi



Air-Way Manufacturing Company
 Hydraulic Fittings and Accessories

