

**JTC: JIC TUBE CAP**

MATERIAL: BRASS  
 ASTM: B-16  
 TYPE: CA-360  
 TEMP RANGE: -65° - 250° F

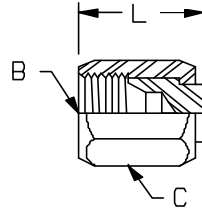

PART NO	TUBE SIZE B	L	C	Working Pressure
JTC4	1/4	.34	9/16	3250 psi
JTC6	3/8	.47	11/16	3250 psi
JTC8	1/2	.53	7/8	3250 psi
JTC10	5/8	.53	1"	3250 psi
JTC12	3/4	.66	1-1/4	3250 psi
JTC16	1"	.63	1-1/2	2600 psi

