

**BTS: JIC TUBE SLEEVE**

MATERIAL: BRASS  
 ASTM: B-111  
 TYPE: CA-443  
 TEMP RANGE: -65° - 250° F

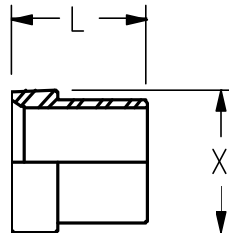

PART NO	TUBE OD	L	X	Working Pressure
BTS2	1/8	.34	.27	3250 psi
BTS4	1/4	.41	.38	3250 psi
BTS6	3/8	.50	.50	3250 psi
BTS8	1/2	.56	.68	3250 psi
BTS10	5/8	.66	.80	3250 psi
BTS12	3/4	.69	.97	3250 psi
BTS16	1"	.78	1.22	2600 psi

