

3325: MNPT HEX NIPPLE

MATERIAL: BRASS
 ASTM: B-16
 TYPE: CA-360
 TEMP RANGE: -65° - 250° F

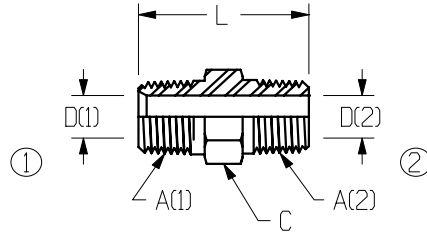

PART NO	A(1) NPT	A(2) NPT	L	C	D (1)	D (2)	Working Pressure
3325-2	1/8-27	1/8-27	.910	.438	.219	.219	1200 psi
3325-4-2	1/4-18	1/8-27	1.02	.562	.346	.217	1200 psi
3325-4	1/4-18	1/4-18	1.12	.562	.344	.344	1200 psi
3325-6-2	3/8-18	1/8-27	1.13	.688	.437	.234	1200 psi
3325-6-4	3/8-18	1/4-18	1.183	.688	.435	.343	1200 psi
3325-6	3/8-18	3/8-18	1.25	.688	.437	.437	1200 psi
3325-8-4	1/2-14	1/4-18	1.34	.875	.591	.346	1200 psi
3325-8-6	1/2-14	3/8-18	1.40	.875	.591	.443	1200 psi
3325-8	1/2-14	1/2-14	1.50	.875	.594	.594	1200 psi
3325-12-8	3/4-14	1/2-14	1.500	1.063	.750	.562	1200 psi
3325-12	3/4-14	3/4-14	1.55	1.063	.748	.748	1200 psi
3325-16	1-1-11/2	1-1-1/2	2.32	1.375	.965	.965	1200 psi

